

NOTE : This drawing contains proprietary and confidential information of Midland Industries...and shall not be copied, loaned or submitted to outside parties for examination without our prior consent.

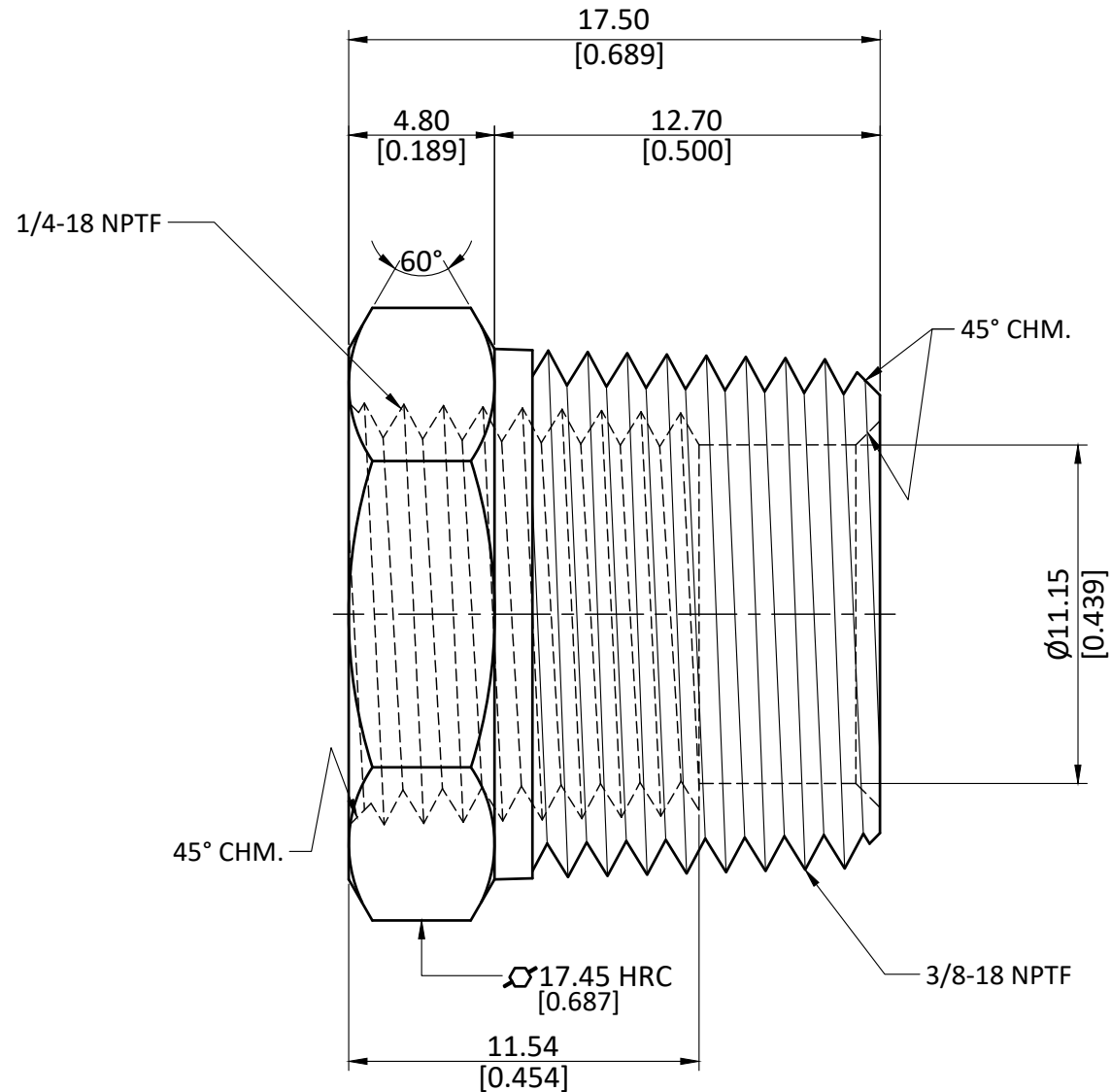

ALL DIMENSION ARE IN MM & INCH.

ROD SIZE: 17.45 Hex RC

PROCESS: NOT APPLICABLE.

ASSEMBLY: NOT APPLICABLE.

DRAWN

CHECKED

APPROVED

PART CODE:

7061110-0604

A.M.

J.P.

S.P.

11/01/2023

11/01/2023

11/01/2023

GRADE:

LF-CW510L

ITEM DESCRIPTION:

LF 7110 3/8 X 1/4 HEX BUSHING

GENERAL TOLERANCE

MM ±0.25

INCH ±0.010

ANGLE ±1°

WEIGHT (gm):

15.50

SCALE:
N.T.S.

REVISION:
01