

NOTE : This drawing contains proprietary and confidential information of Midland Industries...and shall not be copied, loaned or submitted to outside parties for examination without our prior consent.

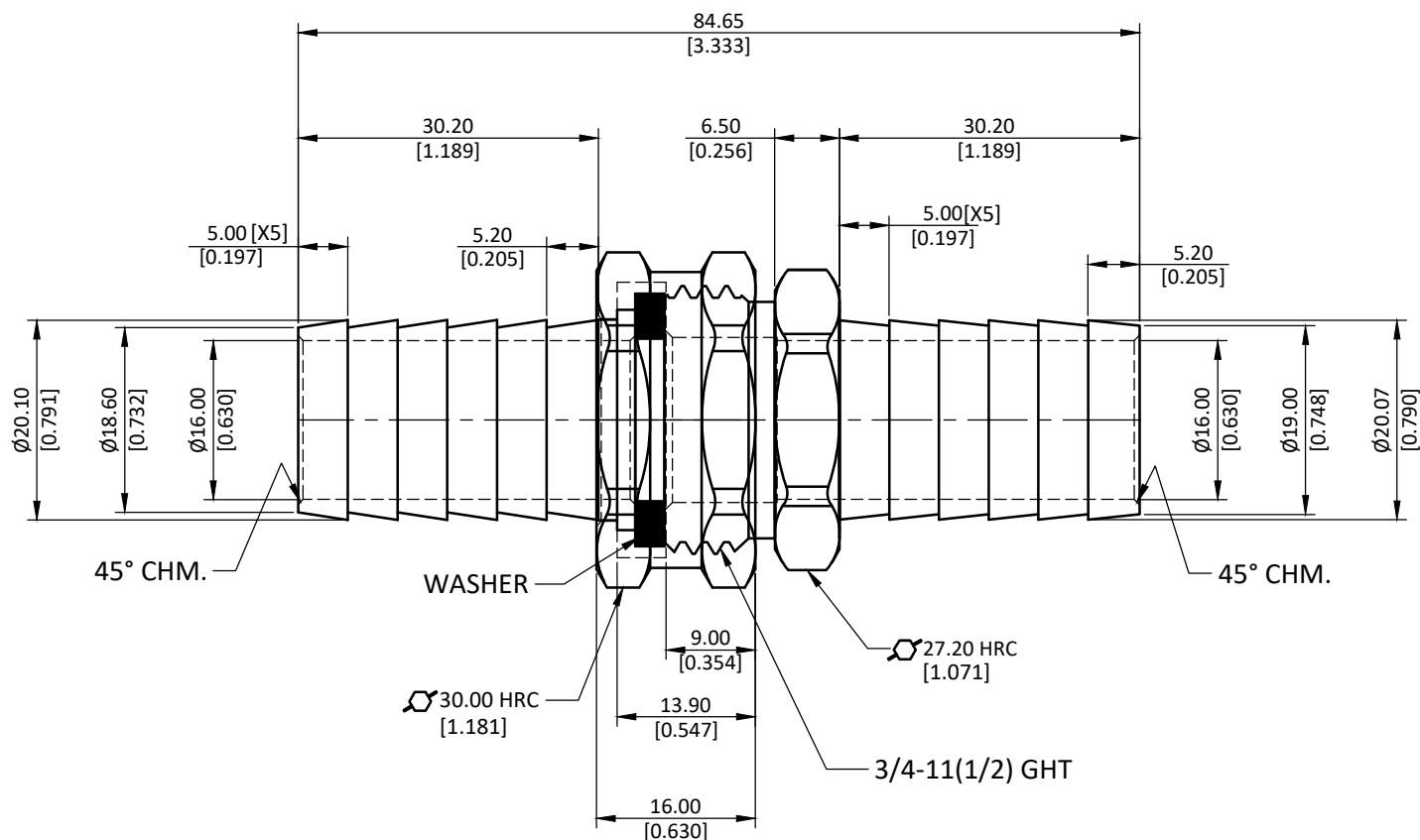

ALL DIMENSION ARE IN MM & INCH.

ROD SIZE: NOT APPLICABLE.

PROCESS: ASSEMBLY

ASSEMBLY: ASSEMBLE WITH 30034 & 30042.

DRAWN

A.B.

11/01/2023

CHECKED

J.P.

11/01/2023

APPROVED

S.P.

11/01/2023

PART CODE:

30029

ITEM DESCRIPTION:

3/4 GH COUPLING 1.19 SHANK

GRADE:

C3604

GENERAL TOLERANCE

MM ±0.25
INCH ±0.010
ANGLE ±1°

WEIGHT (gm):

131.19

SCALE:
N.T.S.

REVISION:
01