

NOTE : This drawing contains proprietary and confidential information of Midland Industries...and shall not be copied, loaned or submitted to outside parties for examination without our prior consent.

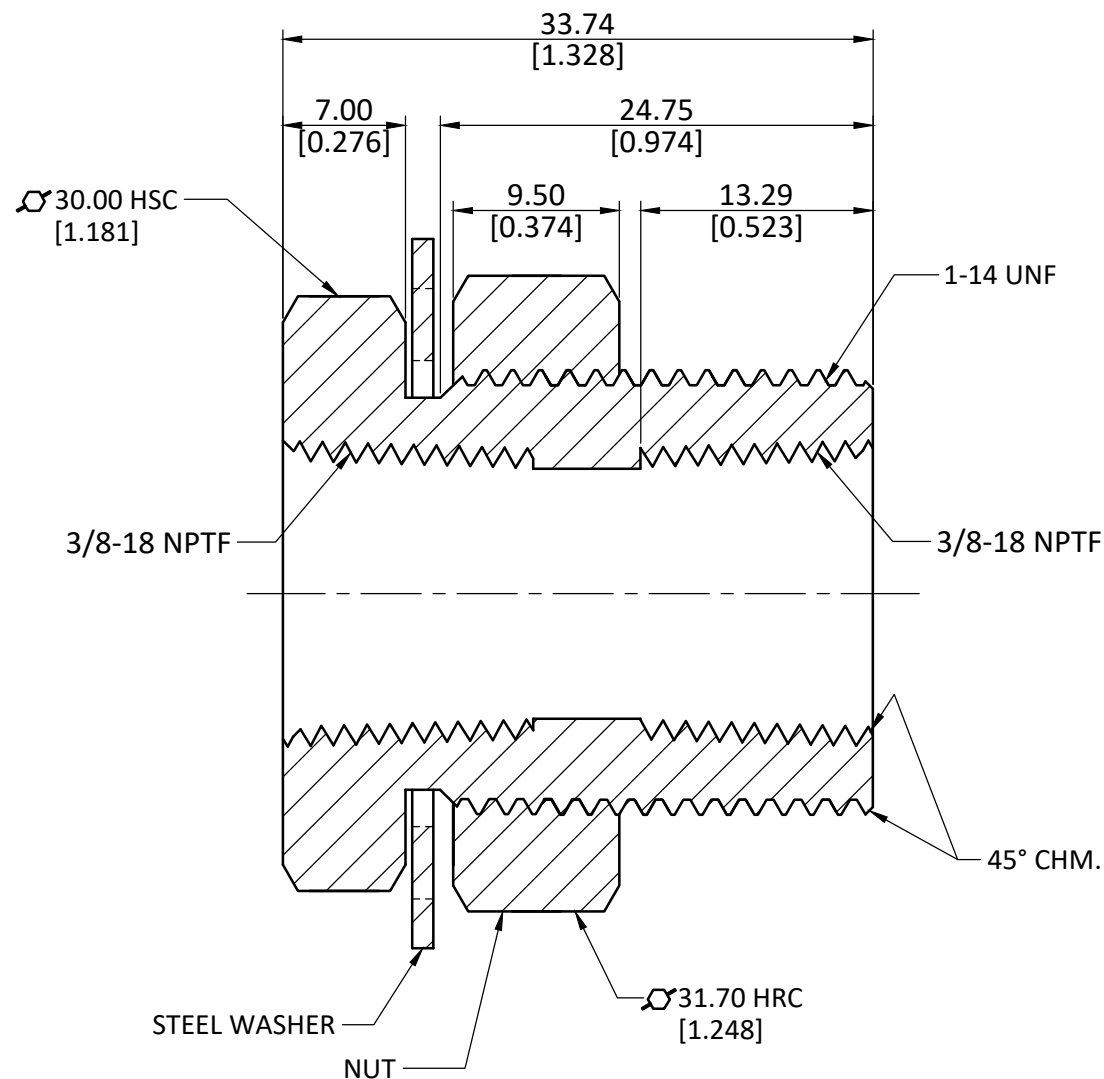

ALL DIMENSION ARE IN MM & INCH.

ROD SIZE: 30.00 Hex SC

PROCESS: ASSEMBLY

ASSEMBLY: ASSEMBLE WITH WASHER & NUT [ASSEMBLY WEIGHT(gm) : 132.10]

DRAWN

A.B.

11/01/2023

CHECKED

J.P.

11/01/2023

APPROVED

S.P.

11/01/2023

PART CODE:

28303

ITEM DESCRIPTION:

3/8FIP X 1-5/16LNG ANCHOR CONN

GRADE:

C3604

GENERAL TOLERANCE

MM ±0.25
INCH ±0.010
ANGLE ±1°

WEIGHT (gm):

94.80

SCALE:
N.T.S.

REVISION:
01