

NOTE : This drawing contains proprietary and confidential information of Midland Industries...and shall not be copied, loaned or submitted to outside parties for examination without our prior consent.

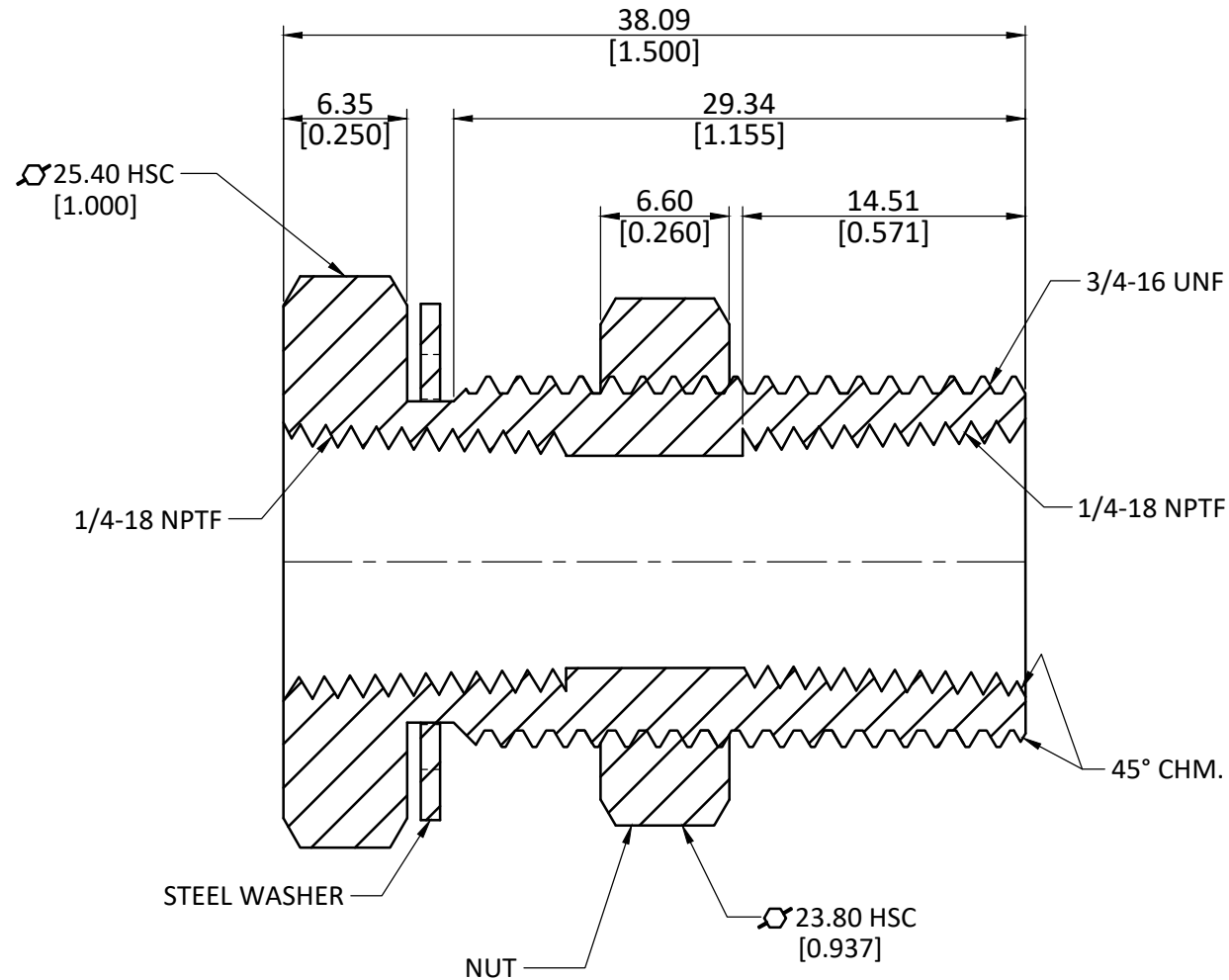

ALL DIMENSION ARE IN MM & INCH.	DRAWN	A.B.	11/01/2023	GRADE:  C3604	GENERAL TOLERANCE MM   ±0.25 INCH  ±0.010 ANGLE   ±1°	
	CHECKED	J.P.	11/01/2023			
	APPROVED	S.P.	11/01/2023			
ROD SIZE: 25.40 Hex SC	PART CODE: 28302		ITEM DESCRIPTION: 1/4FIP X 1-1/2LNG ANCHOR CONN		WEIGHT (gm): 61.00	
PROCESS:ASSEMBLY						
ASSEMBLY: ASSEMBLE WITH NUT & WASHER [ ASSEMBLY WEIGHT(gm) : 77.00 ]					SCALE: N.T.S.	REVISION: 01