

NOTE : This drawing contains proprietary and confidential information of Midland Industries...and shall not be copied, loaned or submitted to outside parties for examination without our prior consent.

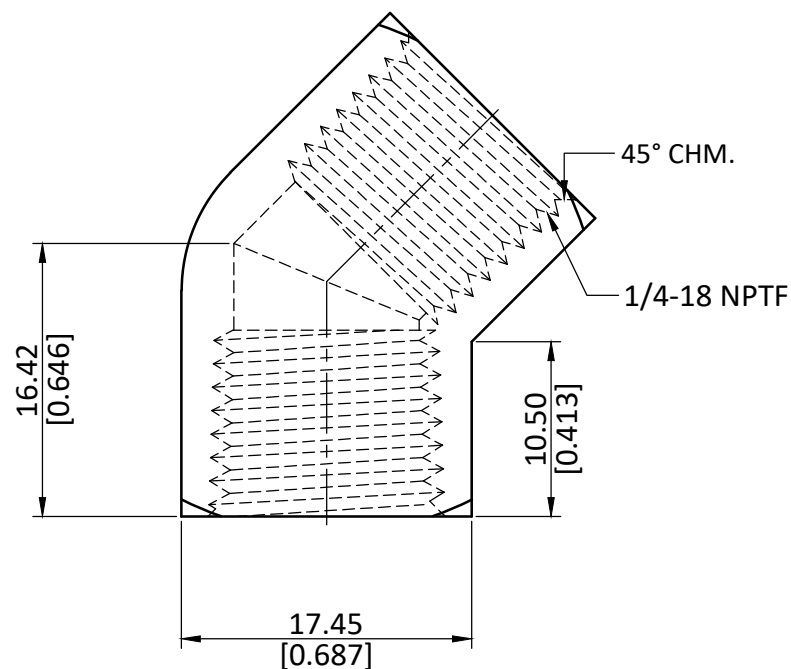
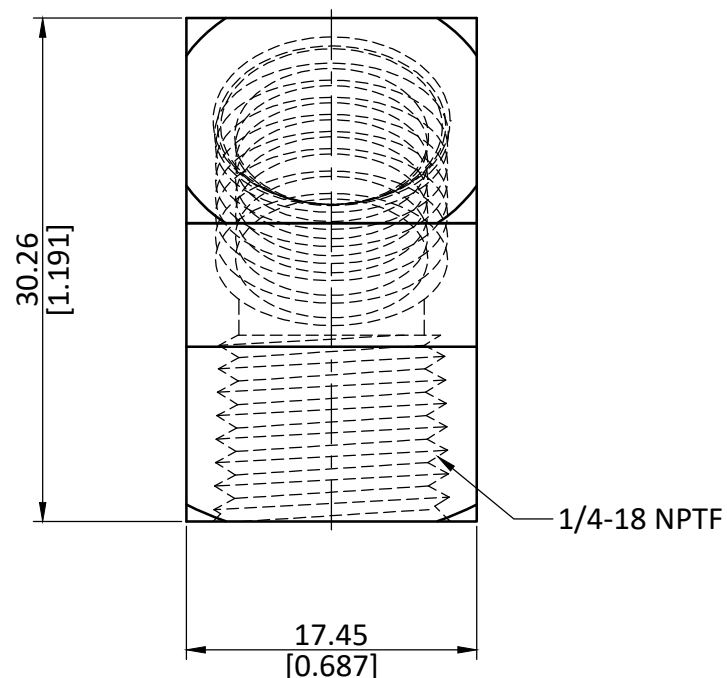

ALL DIMENSION ARE IN MM & INCH.

ROD SIZE: NOT APPLICABLE.

PROCESS: NOT APPLICABLE.

ASSEMBLY: NOT APPLICABLE.

DRAWN

A.B.

11/01/2023

CHECKED

J.P.

11/01/2023

APPROVED

S.P.

11/01/2023

PART CODE:

28019

ITEM DESCRIPTION:

1/4 FIPX FIP BS 45 ELBOW

GRADE:

C3604

GENERAL TOLERANCE

MM ± 0.25
INCH ± 0.010
ANGLE $\pm 1^\circ$

WEIGHT (gm):

43.11

SCALE:
N.T.S.

REVISION:
01