

NOTE : This drawing contains proprietary and confidential information of Midland Industries...and shall not be copied, loaned or submitted to outside parties for examination without our prior consent.

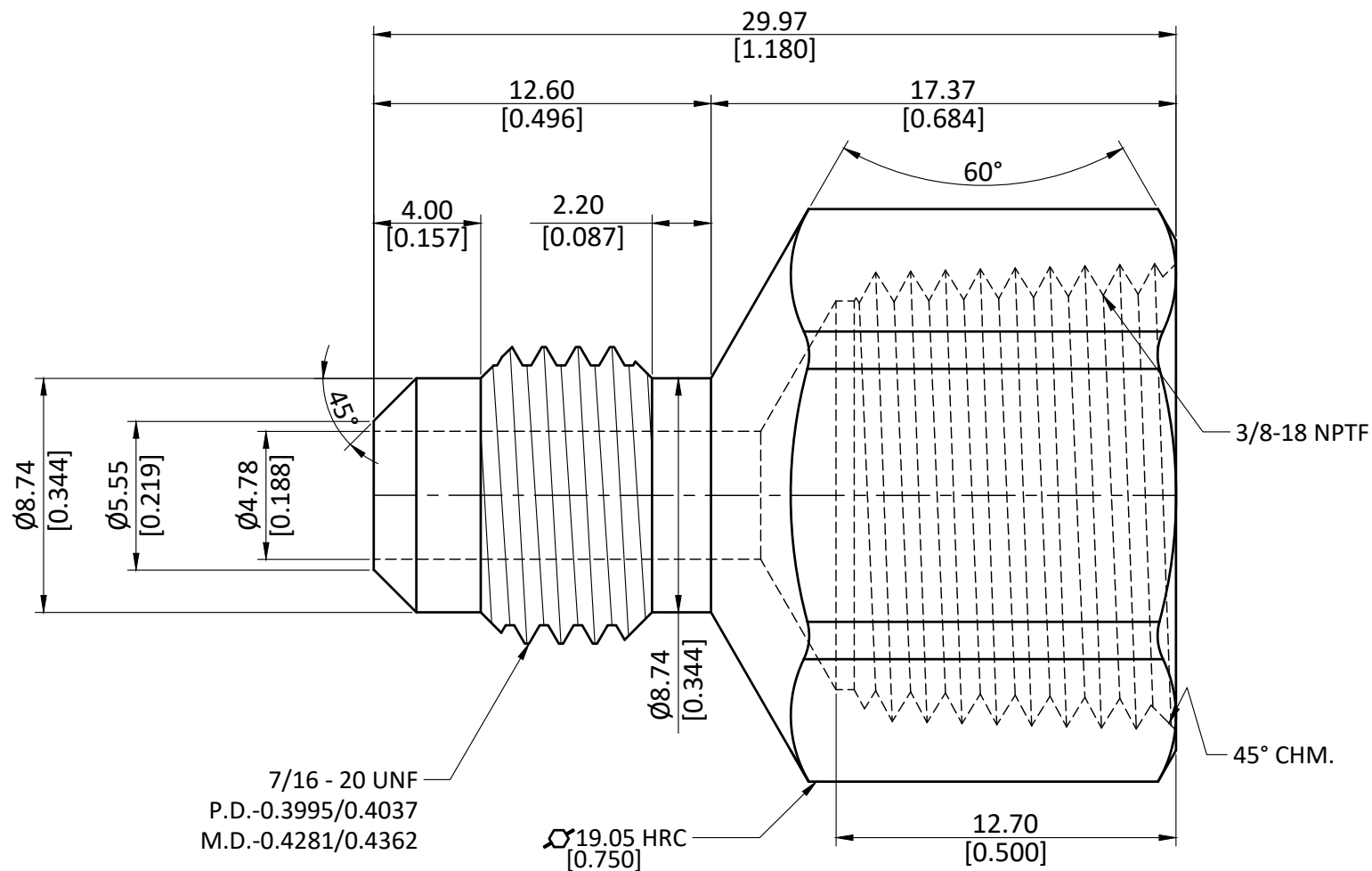

7/16 - 20 UNF  
P.D.-0.3995/0.4037  
M.D.-0.4281/0.4362

19.05 HRC  
[0.750]

3/8-18 NPTF

45° CHM.



ALL DIMENSION ARE IN MM & INCH.

ROD SIZE: 19.05 Hex RC

PROCESS: NOT APPLICABLE.

ASSEMBLY: NOT APPLICABLE.

DRAWN

A.M.

11/01/2023

GRADE:

GENERAL TOLERANCE

CHECKED

J.P.

11/01/2023

C3604

MM ±0.25

APPROVED

S.P.

11/01/2023

INCH ±0.010

PART CODE:

10230

ITEM DESCRIPTION:

1/4 X 3/8 MALE FLARE X FIP ADPT

WEIGHT (gm):

24.70

SCALE: N.T.S.

REVISION: 01